



## 316 Stainless Steel Railing Systems



### Prefabricated Post for Cable for 36" Standard & 42" Guardrail

Cable rail is an efficient railing infill that also provides a clear view through the railing. It is an elegant design alternative and is ideal for use on outdoor decks.

**Standard Saddle Corner**

Fixed Adjustable Fixed

**POST POSITION**

End Center Corner Stair Center Stair End

Pre-drilled Holes available for 1/8" or 3/16" cable.

**MOUNTING OPTIONS**

Fascia Floor

**Cable**

1/8" Cable Assembly, 5' to 50' sections  
3/16" Cable Assembly, 5' to 50' sections

#### Build Requirements

1. Post Height: 36" \_\_\_\_\_ 42" \_\_\_\_\_
2. Type of Saddle: Fixed \_\_\_\_\_ Adjustable \_\_\_\_\_
3. Mounting Condition: Floor \_\_\_\_\_ Fascia \_\_\_\_\_
4. Cable Thickness: 1/8" \_\_\_\_\_ 3/16" \_\_\_\_\_
5. Are there stairs? (rise and run info must be submitted)
6. How many posts are needed?  
(post every 4ft. maximum recommended)  
Ends \_\_\_\_\_ Centers \_\_\_\_\_ Stair Ends \_\_\_\_\_ Stair Centers \_\_\_\_\_
7. Cable Length and Quantity?  
(cables come in 5ft. increments up to 50ft.) \_\_\_\_\_
8. Length of top rail? (ft.) \_\_\_\_\_





\*All parts listed below are manufactured for 1.67" tubing, unless otherwise noted.

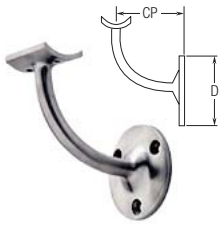

**49-301/424**  
Handrail Bracket  
**CP:** 2.5"  
**D:** 2.56"



**49-733/424**  
Flush Side Outlet Ell  
**W:** 2.56"  
**L:** 2.56"

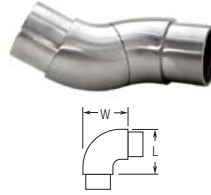

**49-731A/424**  
Adjustable Radius Ell  
**W:** 2.76"  
**L:** 2.76"

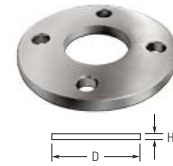

**49-541/424**  
Floor Flange  
**D:** 3.94"  
**H:** 0.32"

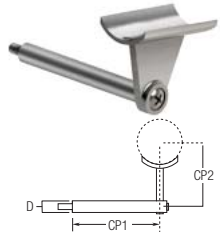

**49-308PM/1H**  
Post-mounted Handrail Bracket  
**Tube:** 1.5"\*  
**CP1:** 2.25"  
**CP2:** 2.125"  
**D:** 0.47"



**49-734/424**  
Flush Tee  
**W:** 3.43"  
**L:** 2.56"



**49-732/424**  
Flush Ell  
**W:** 2.56"  
**L:** 2.56"



**49-540/424**  
Flange Canopy  
**D:** 4.13"  
**CD:** 1.69"  
**H:** 1.0"



**49-352/424**  
Short Handrail Bracket  
**49-352A/424**  
Short Handrail Adj. Saddle  
**49-352L/424**  
Short Corner Saddle



**49-735/424**  
Flush Side Outlet Tee  
**Wall:** 0.08"  
**W:** 3.5"  
**L:** 2.56"



**49-732A/424**  
Adjustable Flush Ell  
**H:** 2.25"



**49-WA103/424**  
Fascia Mount  
**CP:** 1.97"  
**D:** 4.33"



**49-821/424**  
Adjustable Ball Saddle



**49-736/424**  
Flush Cross  
**W:** 3.43"  
**L:** 3.43"



**49-533/424**  
Adjustable Angle Flange  
**D:** 3.35"  
**H:** 2.38"

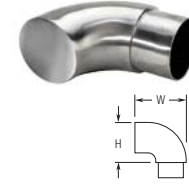

**49-608/424**  
Radius Wall Return  
**W:** 2.56"  
**H:** 2.56"



**49-818/424**  
Perpendicular Collar  
**H:** 0.25"



**49-730/424**  
Flush 135° Angle  
**W1:** 1.97"  
**W2:** 2.60"  
**L:** 3.34"



**49-510/424**  
Wall Flange  
**D:** 3.35"  
**H:** 1.0"



**49-600PF/424**  
Knurled End Cap  
**W:** 1.67"  
**H:** 0.14"



**49-830/424**  
Splice  
**W:** 0.16"



**49-731/424**  
Flush Radius Ell  
**W:** 2.50"  
**L:** 2.56"

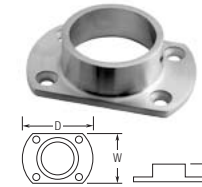

**49-511/424**  
Cut Wall Flange  
**D:** 3.35"  
**W:** 2.12"  
**H:** 1.0"



**49-602/424**  
Rounded End Cap  
**W:** 1.67"  
**H:** 0.83"

## Tubing

ITEM #	MATERIAL	FINISH	OD	WALL THICK
49-A111/20	316	Satin	1.5"	0.06"
49-A114/20	316	Satin	1.67"	0.08"

## Adhesive and Polish

ITEM #	PRODUCT	DESCRIPTION
00202	Lavi Metal Polish	Polish
00201	Loctite 326	Adhesive
00211	Loctite 7649	Primer
00203	MAAS Stainless Steel Cleaner	Cleaner
00204	MAAS Polishing Cloth	Cloth

